

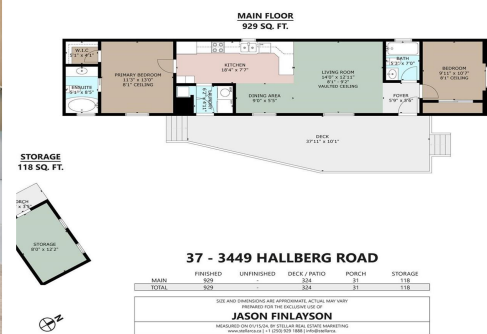

**PEMBERTON  
HOLMES** REAL ESTATE  
ESTABLISHED 1887

**Your New Home Awaits!**

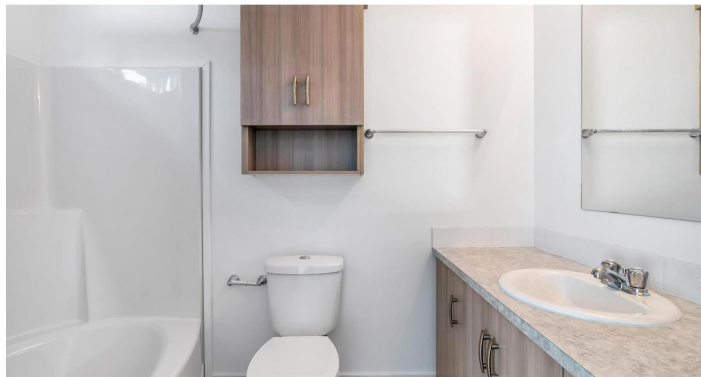
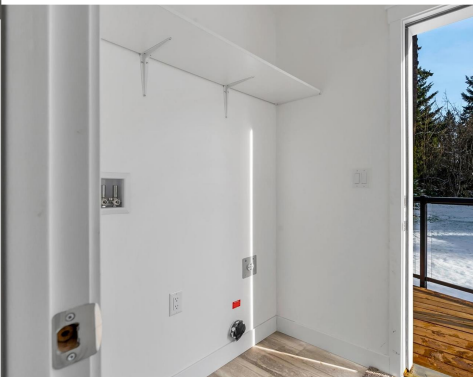

**37-3449 Hallberg Pk**

**\$349,900**

## Move in ready

Welcome to the newest Knightway modular project, located in the Seabird Community just minutes from Nanaimo Airport. This brand new, turn-key 2-bed, 2 bath boasts an open concept living, an abundance of natural light, in-house laundry and ample storage, leaving you with nothing more to desire. The large deck and well-maintained yard make this home perfect for outdoor hosting. Welcome to a new era of attainable contemporary living with Knightway Mobile Haulers.

## FEATURES

<b>Area</b>	<b>Extension</b>
<b>Bedrooms</b>	<b>2</b>
<b>Bathrooms</b>	<b>2</b>
<b>Lot Size</b>	
<b>Floor Space</b>	<b>929</b>
<b>Age</b>	<b>2022</b>
<b>Taxes</b>	<b>0</b>
<b>Tax Year</b>	<b>2024</b>
<b>MLS#</b>	<b>951392</b>



### Jason Finlayson

Representative

(250) 746-8123

[jason@jasonfinlayson.com](mailto:jason@jasonfinlayson.com)

[www.jasonfinlayson.com](http://www.jasonfinlayson.com)

23 Queens Road



**PEMBERTON  
HOLMES** REAL ESTATE  
ESTABLISHED 1887